



Features

- PXA270, 520 MHz CPU
- Linux kernel 2.6.19 Inside
- Embedded Service: Web Server, FTP Server, Telnet Server, SSH Server
- 64 MB Flash, 128 MB SDRAM
- Built-in Ethernet, USB, RS-232, RS-485 Ports
- Built-in 800 × 600 VGA Port
- Built-in Audio with Microphone-In and Earphone-Out
- I/O Expansion Bus: XW-Board
- Operating Temperature: -25 ~ +75°C



Introduction

The LP-51xx series is equipped with a PXA270 CPU (520 MHz) and running a Linux kernel 2.6.19 operating system, multiple communication interfaces, such as VGA, USB, Ethernet, RS-232/485 and audio ports. Further more, it also contains an optional I/O expansion board to implement various I/O functions, such as DI, DO, A/D, D/A, Timer/Counter, UART, flash memory, or battery backup SRAM.

Main advantage of the LP-51xx series is its high quality control system, including its stability, small core size, optional I/O expansion board, support for Web services (Web/FTP/Telnet/SSH server), and multiple development environments (LinPAC SDK for Linux and Windows environment using the GNU C language, GUI software), etc., all of which give users the best features of both traditional PLCs and Linux capable PCs, meaning that it is one of the most powerful and flexible embedded control systems available.

Appearance

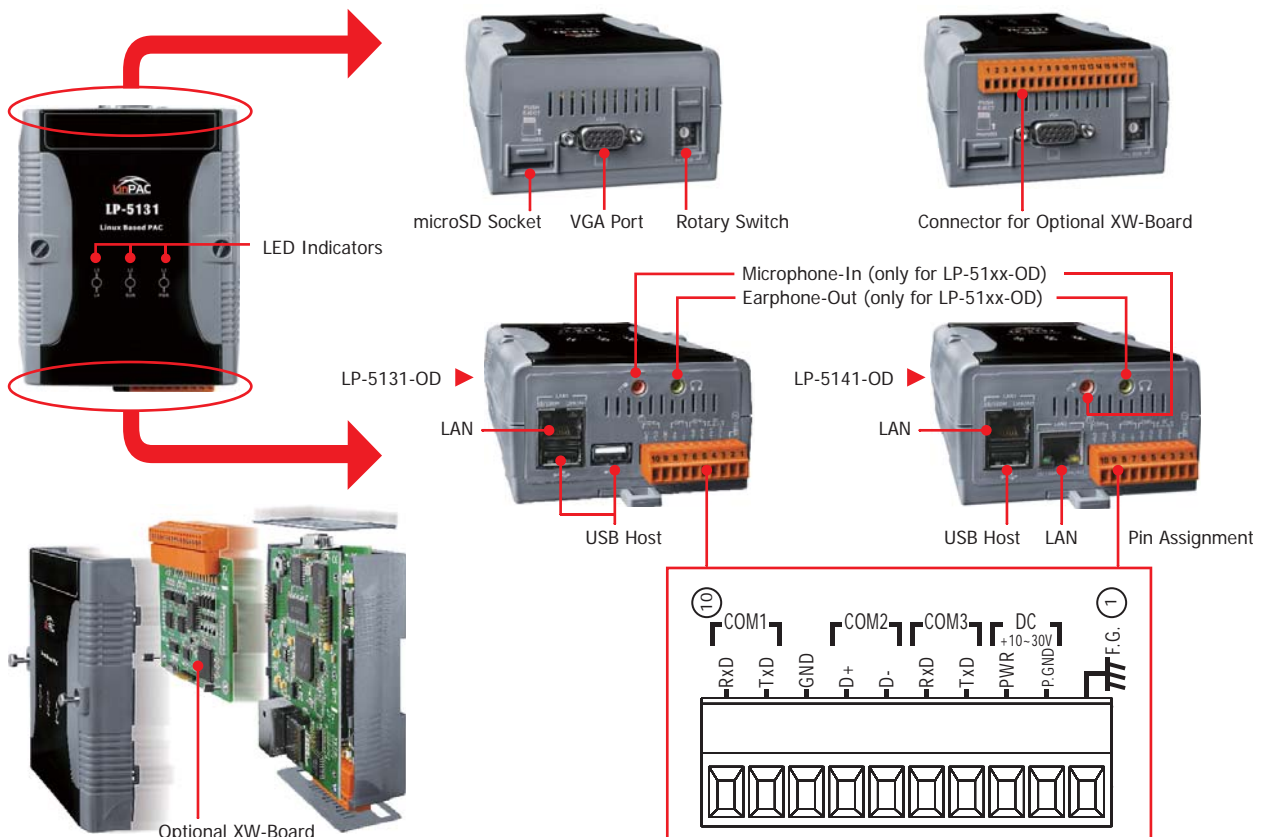

Specifications

Models	LP-5131	LP-5131-OD	LP-5141	LP-5141-OD
System Software				
OS	Linux kernel 2.6.19			
Embedded Service	Web Server, FTP Server, Telnet Server, SSH Server			
SDK Provided	Standard LinPAC SDK for Windows and Linux by GNU C language			
CPU Module				
CPU	PXA270, 520 MHz			
SDRAM	128 MB			
NVRAM	31 Byte (Battery backup, data valid up to 10 years)			
Flash	64 MB			
EEPROM	16 KB			
Expansion Flash Memory	microSD socket with one 4 GB microSD card (support up to 32 GB microSDHC card)			
RTC (Real Time Clock)	Provide second, minute, hour, date, day of week, month, year			
64-bit Hardware Serial Number	Yes, for Software Copy Protection			
Dual Watchdog Timers	Yes			
LED Indicator	3 Dual-Color LEDs (PWR, RUN, L1 ~ L4; RUN, L1 ~ L4 for user programmable)			
Rotary Switch	Yes (0 ~ 9)			
VGA & Communication Ports				
VGA	Yes 640 × 480 / 800 × 600			
Ethernet	RJ-45 x 1, 10/100 Base-TX (Auto-negotiating, Auto MDI/MDI-X, LED indicators)		RJ-45 x 2, 10/100 Base-TX (Auto-negotiating, Auto MDI/MDI-X, LED indicators)	
USB 1.1 (host)	2		1	
Audio (Microphone-In and Earphone-Out)	-	Yes	-	Yes
COM 1	RS-232 (Rx, Tx and GND); Non-isolated			
COM 2	RS-485 (Data+, Data-); 2500 Vdc isolated			
COM 3	RS-232 (Rx, Tx and GND); Non-isolated			
I/O Expansion				
I/O Expansion Bus	Yes, one optional XW-board			
Mechanical				
Dimensions (W x L x H)	91 mm x 132 mm x 52 mm			
Installation	DIN-Rail			
Environmental				
Operating Temperature	-25 ~ +75°C			
Storage Temperature	-30 ~ +80°C			
Ambient Relative Humidity	10 ~ 90% RH (non-condensing)			
Power				
Input Range	+10 ~ +30 Vdc			
Isolation	1 kV			
Consumption	4.8 W	6 W	4.8 W	6 W

Ordering Information

LP-5131-EN CR	PAC with Linux kernel 2.6.19 and one LAN port (English Version of OS) (RoHS)
LP-5131-OD-EN CR	PAC with Linux kernel 2.6.19 and one LAN port and Audio (English Version of OS) (RoHS)
LP-5141-EN CR	PAC with Linux kernel 2.6.19 and two LAN ports (English Version of OS) (RoHS)
LP-5141-OD-EN CR	PAC with Linux kernel 2.6.19 and two LAN ports and Audio (English Version of OS) (RoHS)

Option Accessories

DP-660	24 Vdc/2.5 A, 60 W and 5 Vdc/0.5 A, 2.5 W Power Supply with DIN-Rail Mounting
DP-1200 CR	24 Vdc/5.0 A, 120 W Power Supply with DIN-Rail Mounting (RoHS)
MDR-20-24 CR	24 Vdc/1.0 A, 24 W Power Supply with DIN-Rail Mounting (RoHS)
MDR-60-24 CR	24 Vdc/2.5 A, 60 W Power Supply with DIN-Rail Mounting (RoHS)
XW-Board	Add-on I/O Expansion Board